

K7L-XXWF

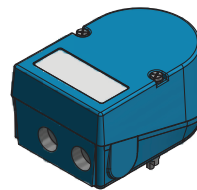

K7L-XXGF & K7LXXDF

MODEL NUMBER

K7L-M2WFNMM00001

PRODUCT LINE

Switchbox K7L

SPECIFICATIONS

Enclosure	Aluminum
Bus/Sensor	(2) SPDT Mechanical Switches
Area Classification	No Approvals
Visual Display	Flattop
Shaft	NAMUR
Conduit Entries	(2) M20
O-Rings	Silicone
Pilot	No Pilot
Spool Valve	No Spool Valve
Valve Cv	No Valve Cv
Manual Override	No Manual Override
Regional Certification	250°C / 3 hours
N Switch	No N Switch

WIRING DIAGRAM

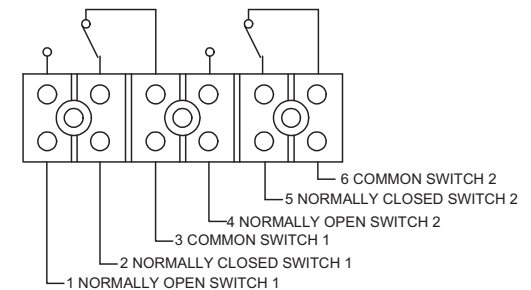

NAMEPLATE



IP66/67
 SWITCH: 125-250VAC/10A; 30VDC/6A
 SOLENOID: 250V/2A
 250°C / 3 hours
 Cable Entry: M20

Topworx
 3300 Fern Valley Road
 Louisville KY 40213 USA
 +1 502 969 8000
 Made in the UK

Model #:

Serial #:

Current as of August 25, 2021 – Subject to change without notice.

TOPWORX

3300 Fern Valley Road
 Louisville, KY 40213

(502)969-8000 PH
 (502)969-5911 FAX
 www.topworx.com