

K7L-XXWF

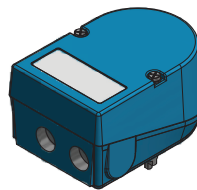

K7L-XXGF & K7LXXDF

MODEL NUMBER

K7L-0XDFNMM

PRODUCT LINE

Switchbox K7L

SPECIFICATIONS

Enclosure	Aluminum
Bus/Sensor	4-20mA Transmitter
Area Classification	ATEX/IECEX, Ex ia and Ex tb
Visual Display	Flattop
Shaft	NAMUR
Conduit Entries	(2) M20
O-Rings	Silicone
Pilot	No Pilot
Spool Valve	No Spool Valve
Valve Cv	No Valve Cv
Manual Override	No Manual Override
Regional Certification	No Regional Certification
N Switch	No N Switch

WIRING DIAGRAM

TRANSMITTER

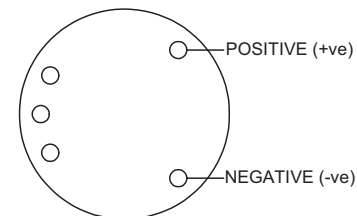

NAMEPLATE



TopWorx
3300 Fern Valley Road
Louisville KY 40213 USA
+1 502 969 8000
Made in the UK

T-PT-D-IEC
Baseefa 16ATEX0140/ IECEX BAS 16.0108
Ex ia IIC T6/T4 Gb; Ex tb IIIC T85°C/T135°C Db
Ta: -40°C to 40°C/70°C; IP66/67
XMIT: Ui:30V, Ii:120mA, Pi:0.84W, Ci:1nF, Li:10µH
REMOTE CONNECTIONS: Ui=30VDC MAX
Cable Entry: M20

Model #:

Serial #:

Current as of August 25, 2021 – Subject to change without notice.

TOPWORX

3300 Fern Valley Road
Louisville, KY 40213

(502)969-8000 PH
(502)969-5911 FAX
www.topworx.com